



SINGAPORE

USER GUIDE: **How to Send Us a Feedback**

Need more help?

Call or write to us



Helpdesk

Email us @
sghelpdesk@amway.com



Call Centre

Call +65 6550 9911
Monday to Friday
9am to 7pm
Saturday
12pm to 7pm
(excluding Sunday & public holiday)



Chatbot

You can also chat with our Amway Chatbot button at the bottom right on the website screen to get started!

How to send us a feedback

1

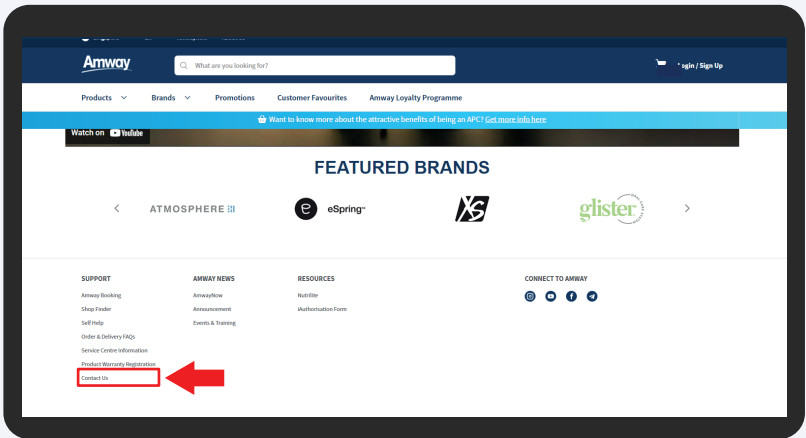

Navigate to the footer and select **Contact Us** to email us.

2

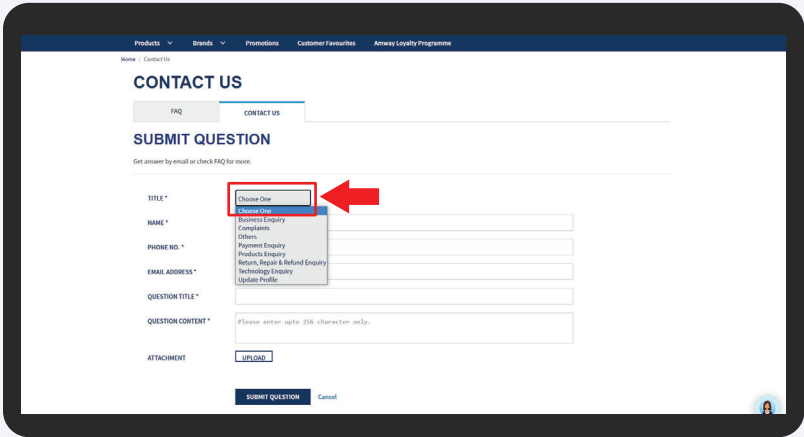

Select a **Title** from the dropown menu for your enquiry.

How to send us a feedback

3

Fill in your personal details and explain the details of your enquiry.

4

Upload a screenshot/picture of the issue encountered and Click **Submit Question** to proceed.

How to send us a feedback

5

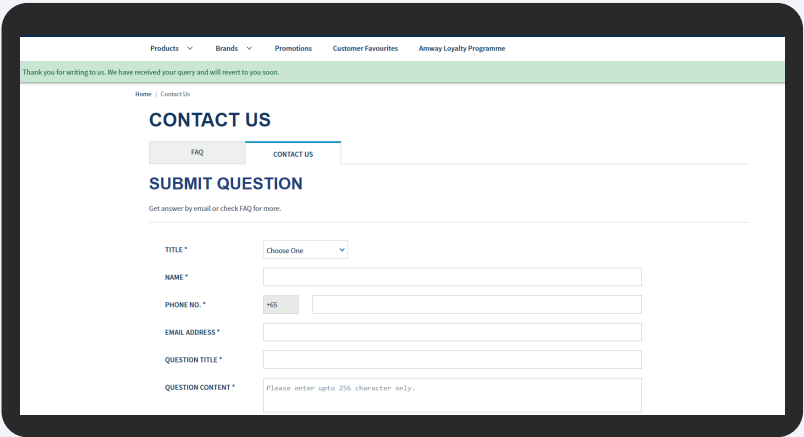

The screenshot shows the 'CONTACT US' page on the Amway website. At the top, there is a navigation bar with links for Products, Brands, Promotions, Customer Favourites, and Amway Loyalty Programme. Below this is a green banner with the text 'Thank you for writing to us. We have received your query and will revert to you soon.' The main heading is 'CONTACT US', with a sub-heading 'SUBMIT QUESTION'. Below the heading, there is a form with the following fields: TITLE * (with a dropdown menu), NAME * (text input), PHONE NO. * (with a '+95' prefix button and a text input), EMAIL ADDRESS * (text input), QUESTION TITLE * (text input), and QUESTION CONTENT * (text input with a note 'Please enter upto 256 character only.').

Your email enquiry had submitted successfully, the relavant department will revert to you soon.

How to send us a feedback

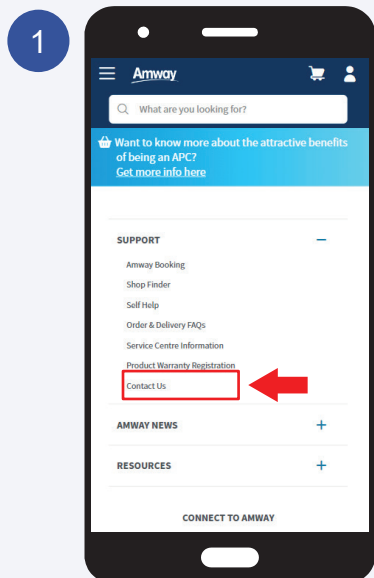

Navigate to the footer and select **Contact Us** to email us.

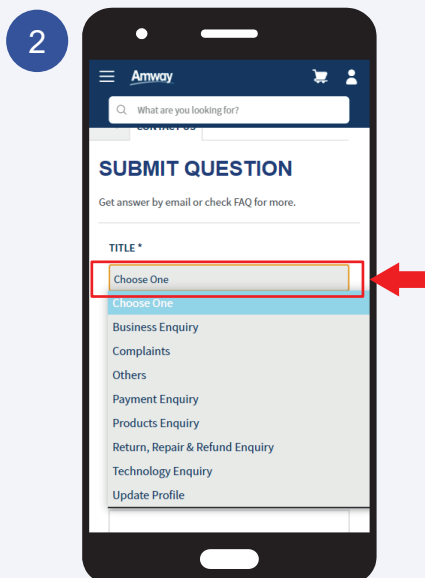

Select a **Title** from the dropdown menu for your enquiry.

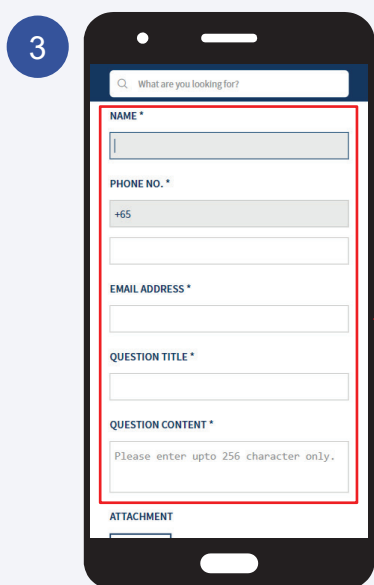

Fill in your personal details and explain the details of your enquiry.

How to send us a feedback

4

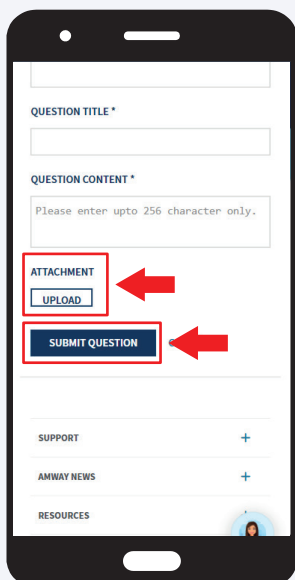

Upload a screenshot/
picture of the issue
encountered and Click
Submit Question to
proceed.

5

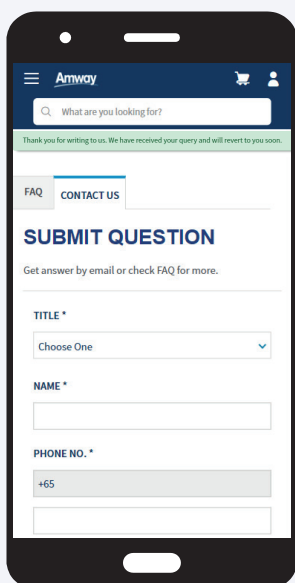

Your email enquiry had
submitted successfully,
the relevant department
will revert to you soon.